

reception desks

Your Vision. Our Execution. Fine Furnishings.



ARD
Arnold Reception Desks, Inc.

Arnold Reception Desks offers one of the most comprehensive collections of task-oriented reception furniture available to the contract industry that is not only functional, but aesthetically pleasing and most importantly — value oriented.

Shape, style, size and configuration can be specified to fit virtually any space, from high traffic reception areas to luxurious executive offices.

This catalog shares an overview of our contemporary, transitional and traditional styles, including a number of new ones, that can be specified in wood, laminate, or both, and transaction countertops that are available with stone inlay or overlay options. A custom style, or merging of styles, can also be manufactured by ARD.

Our objective at Arnold Reception Desks is to always provide our clients with flexibility while maintaining the highest quality and value.

Please consider this catalog a reservoir of design ideas that can be transformed by your imagination to create the perfect reception desk for your area.



Overview

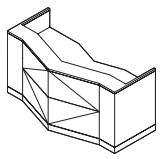

Adagio
page 19

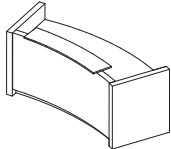

Arcus
page 11

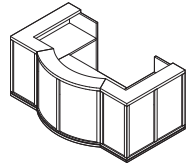

Ascona
page 20

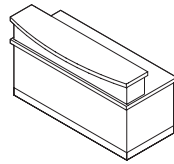

Aspen
page 28

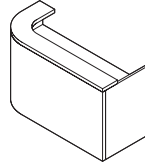

Beta
page 27

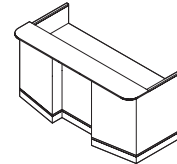

Bravado
page 21

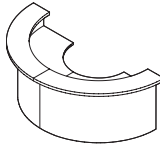

Concord
page 25

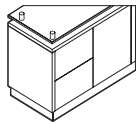

Credenzas
page 30

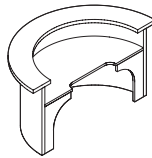

Crescent
page 16

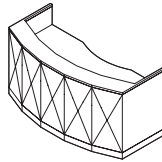

Diamonte
page 21

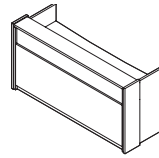

Fusion
page 5

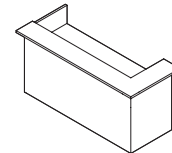

Galleria
page 29

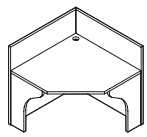

Galleria
page 29

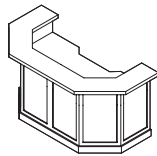

Kent
page 15

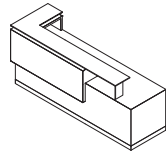

Kubist
page 2

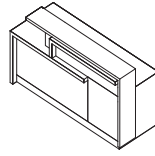

Kubist Linea
page 3

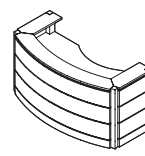

Modena
page 14

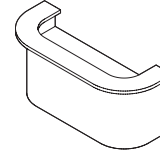

Omega
page 27

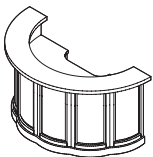

Pembroke
page 24

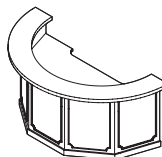

Pentagon
page 26

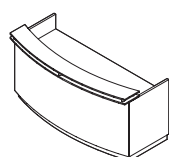

Prismo Atlantis
page 7

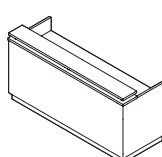

Prismo Como
page 6

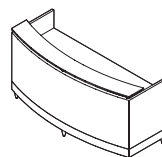

Prismo Millenium
page 10

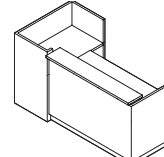

Ravenna
page 4

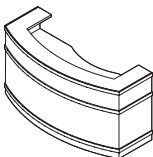

Regent
page 19

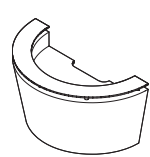

Rio
page 12

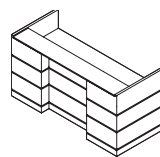

Siena
page 13

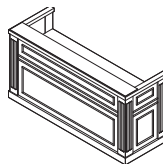

Somerset
page 18

Series	Page
Kubist	2
Kubist Linea	3
Ravenna	4
Fusion	5
Prismo Como	6
Prismo Atlantis	7
Prismo Millenium	10
Arcus	11
Rio	12
Siena.....	13
Modena	14
Kent	15
Crescent	16
Somerset	18
Regent	19
Adagio	19
Ascona	20
Bravado	21
Diamonte	21
Pembroke	24
Concord	25
Pentagon	26
Omega	27
Beta	27
Aspen	28
Galleria	29
Credenzas.....	30
Finishes.....	31
Options	32

Kubist



Kubist features 1/2" anodized aluminum counter on aluminum standoffs, laminate subtop, wood chassis and flush metal laminate toe kick. A glass counter is a popular alternative.



aluminum standoffs



laminate subtop

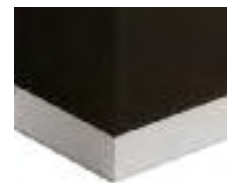

metal laminate toe kick

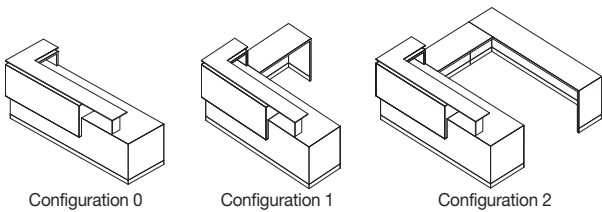

Configuration 0

Configuration 1

Configuration 2

Kubist Linea



waterfall counter

Clean, sharp lines make the Kubist Linea stand out in any lobby. The 1-1/2" stone waterfall counter frames the wood chassis, glass etched front panel and metal toe kick.



metal toe kick

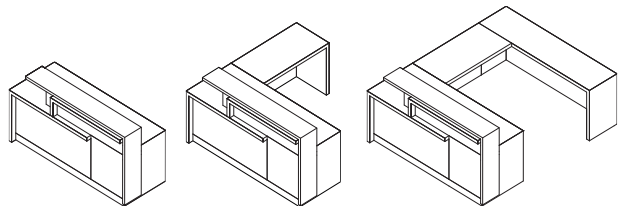

Configuration 0

Configuration 1

Configuration 2

Ravenna

Ravenna typically has a two-tone finish, stone counter on metal stand-offs and flush metal toe kick.



marble countertop with bevel



metal standoffs

Designed by Daniel de Siena, Milo Kleinberg Design Associates



wood monolith

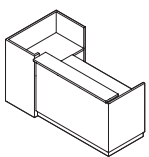

Configuration 0

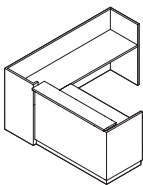

Configuration 1

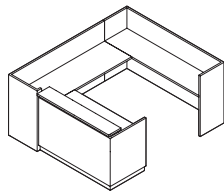

Configuration 2



Fusion features a stone counter, frosted glass clerestory, sketch face veneer on desk front and accent side panels.



accent side panel

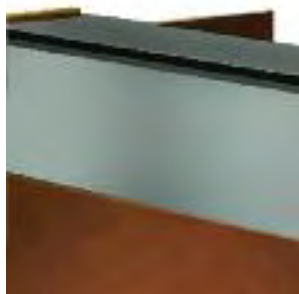

glass clerestory

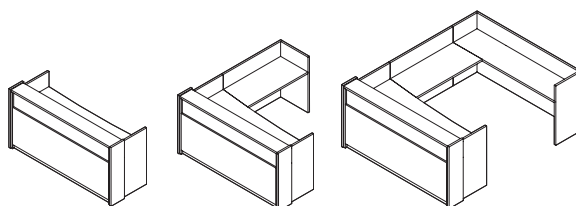

Configuration 0

Configuration 1

Configuration 2

Prismo Como



Elegant yet economical, the Prismo Como comes standard with a glass counter on metal stand-offs and recessed toe kick with a rectilinear chassis.

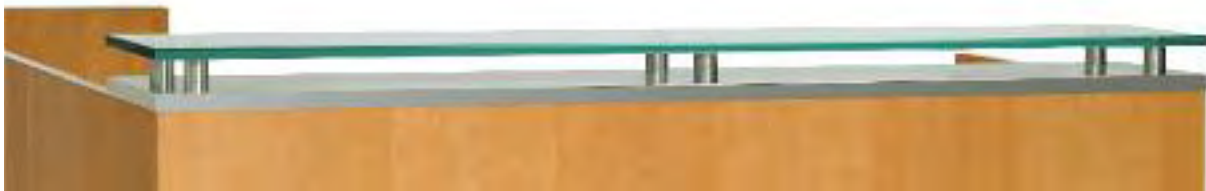

Prismo style glass counter



recessed toe kick



metal stand-offs

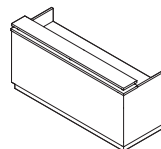

Configuration 0

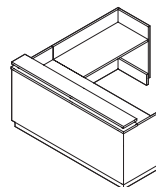

Configuration 1

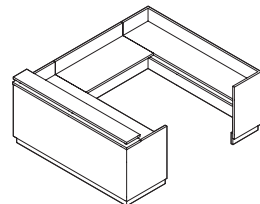

Configuration 2

Prismo Atlantis



A subtle bow-front, glass counter on metal stand-offs and recessed toe kick makes the Prismo Atlantis one of our most popular models.



metal standoffs



arced glass counter



optional metal reveals

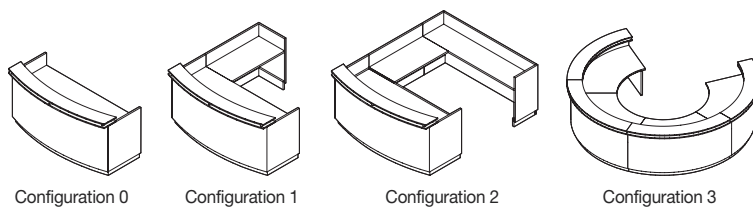



unlocking your vision



Prismo Millenium



clear glass counter with polished edges

Prismo Millenium features a 3/4" thick clear glass counter with polished edges supported by metal stand-offs on metal laminate subtop and conical metal legs.



metal stand-offs and subtop

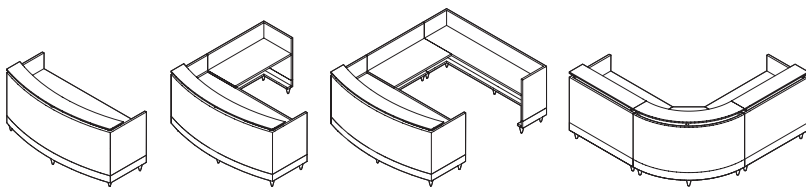

Configuration 0

Configuration 1

Configuration 2

Configuration 3



conical metal legs

The unique concave front of the Arcus will make an immediate statement in your lobby area. This line features a concave chassis with 3" thick end panels, a clear glass transaction counter on metal standoffs, and a recessed metal laminate toe kick. Shown here with optional leather tiles.



curved construction



metal standoffs



recessed metal toe kick with optional lighting

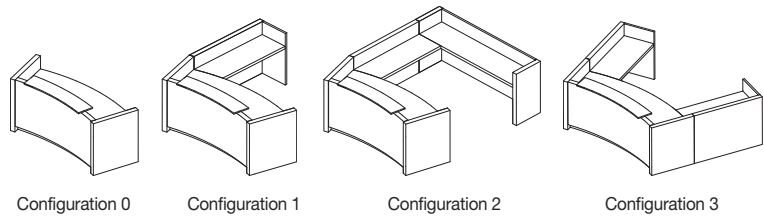

Configuration 0

Configuration 1

Configuration 2

Configuration 3



Rio



The refined taper of the Rio chassis finds an echo in the tapered metal stand-offs.



sweeping clear glass counter design



stainless steel stand-offs



tapered wood chassis

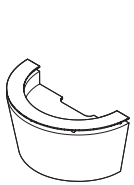

Configuration 0

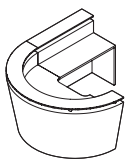

Configuration 1

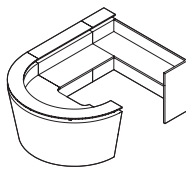

Configuration 2

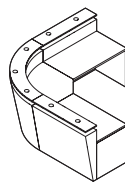

Configuration 3

The deep horizontal reveals and discrete glass counter confer the Sienna with an unmistakable architectural resonance.

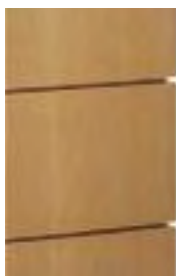

horizontal reveals



polished edge glass counter



recessed center section

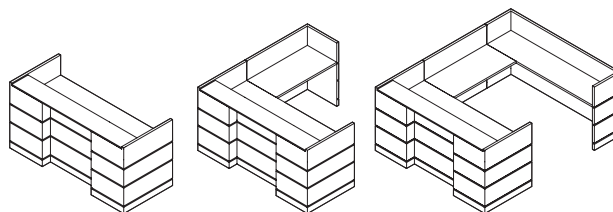

Configuration 0

Configuration 1

Configuration 2

Modena



The black reveals and columns of the Modena highlight the craftsmanship of ARD and its team of experienced woodworkers.

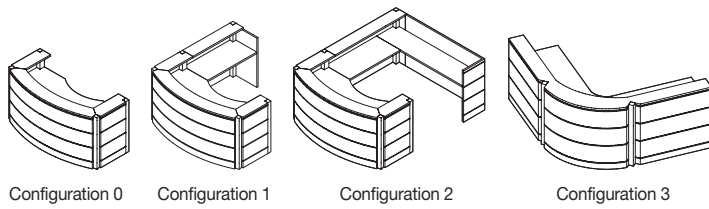

Configuration 0

Configuration 1

Configuration 2

Configuration 3



black reveals and columns





marble inlay countertop



raised wood panels

The Kent style, with its solid wood-raised panels and stone inlaid counter, creates a powerful aura of stability and gravitas.

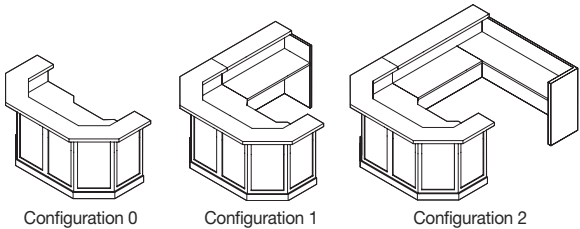

Crescent

A perennial favorite, the Crescent lends itself to many styles, features and configurations.



Shown here with optional glass counter.



raised glass countertop

Crescent is available with inside overhang, outside overhang (desk height only), or inside and outside overhang transaction countertops.



counter overhang



stone inlay countertop

Crescent



Baseboard finishing options are available.



metal toe kick



wood molding



flush wood

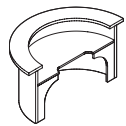

Configuration 0

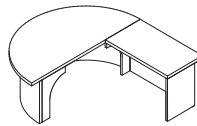

Configuration 1

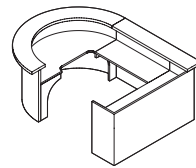

Configuration 2



Somerset



fabric tackboard



wood capped chassis

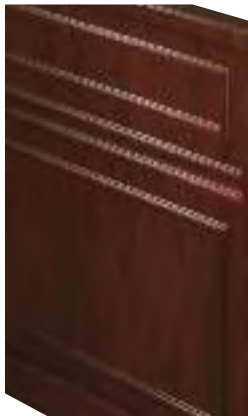

chair rail moldings



fluted columns

The Somerset draws its inspiration from classical architecture. A stone inlay, fluted columns and applied moldings are standard.

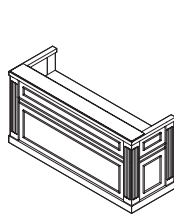

Configuration 0

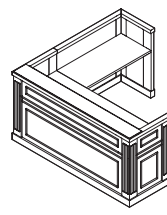

Configuration 1

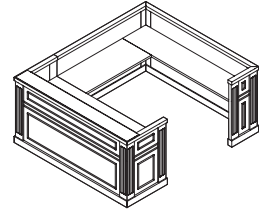

Configuration 2

Regent



A bow-shaped chassis and counter with solid wood molding at worksurface and baseboard heights makes the Regent a transitional winner.



wood capped chassis



wood moldings

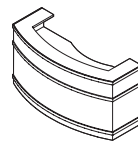

Configuration 0

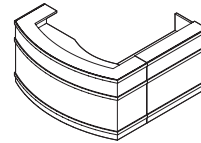

Configuration 1

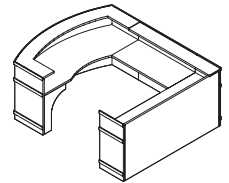

Configuration 2

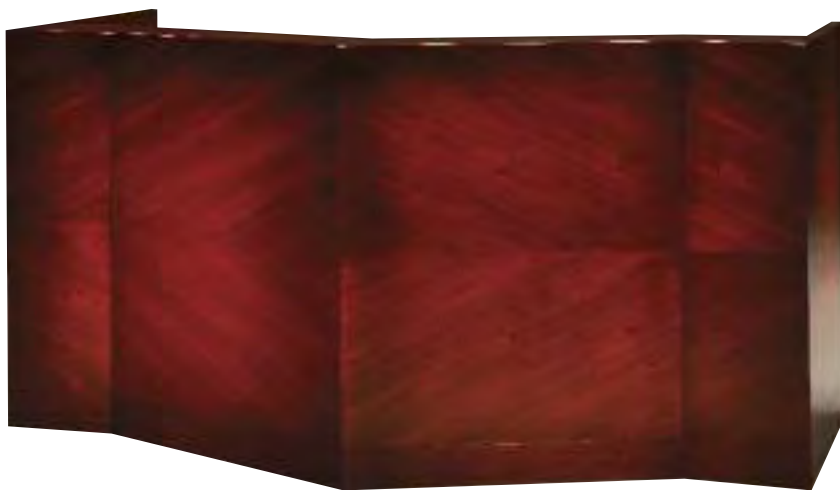

Adagio

Adagio features a veneer laid up in a herringbone pattern, horizontal grain on side panels, flush wood counter with square solid wood edge and flush wood toe kick.

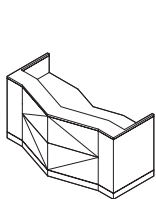

Configuration 0

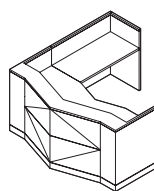

Configuration 1

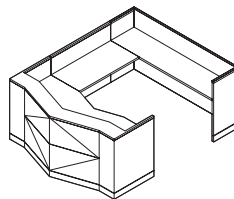

Configuration 2



granite inlay



flush wood toe kick

Ascona



wood countertop



granite inlay countertop

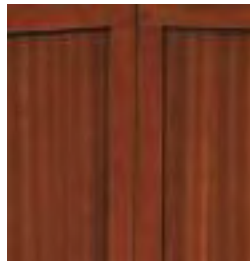

wood framing

Inspired by Biedermeier furniture style, the Ascona has an understated elegance and can be easily customized to fit large lobby areas.

Ascona features solid wood framing around veneer fields, with a bow-shaped center section. Wood counter is typical but stone inlay is also available.

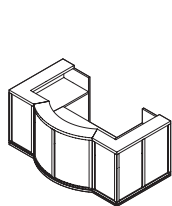

Configuration 0

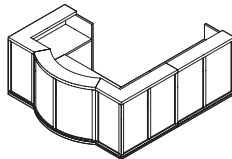

Configuration 1

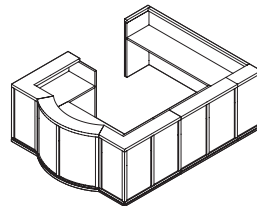

Configuration 2



optional marble inlay

Bravado

Bravado features an angled main desk with recessed center panel, absolute black granite counter and horizontal kerf reveals.



absolute black granite



recessed center panel

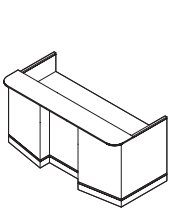

Configuration 0

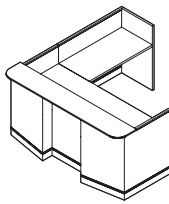

Configuration 1

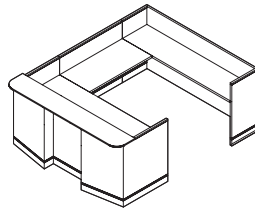

Configuration 2



Diamonte

Diamonte features selected veneers forming diamond shaped panels on front of chassis with solid wood bevel edge and a 10" deep counter.



beveled edges



diamond form

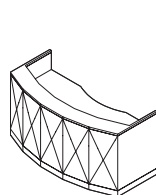

Configuration 0

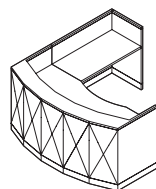

Configuration 1

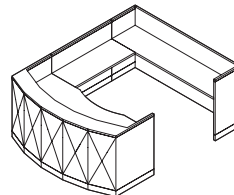

Configuration 2

KANTAR



KANTAR WORLDWIDE

building your vision

Pembroke



Solid wood, convex raised panels give the Pembroke a distinctive look.



convex raised panels

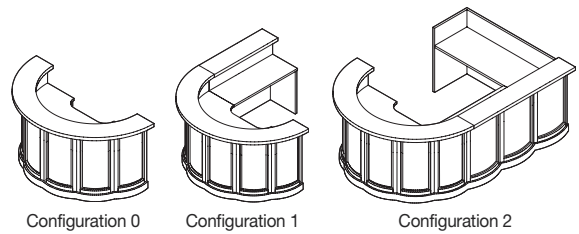

Configuration 0

Configuration 1

Configuration 2





The Concord is the Proteus of the ARD collection. Its cornerstone quarter circle can be configured in a myriad of shapes.



marble inlay

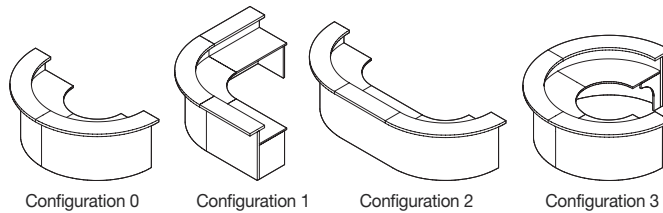

Configuration 0

Configuration 1

Configuration 2

Configuration 3



Pentagon

The Pentagon blends well into any lobby or office with a traditional decor.

Featuring a semi-circular counter with flat angled panels, Pentagon is available in receptionist and executive heights.



angled chassis panels



intricate raised molding detail



countertop

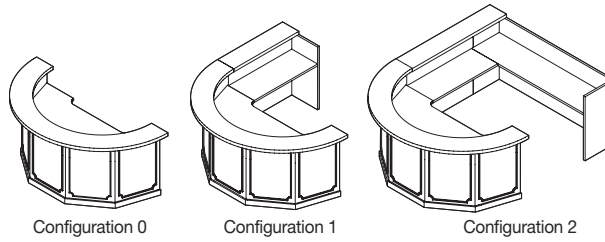

Configuration 0

Configuration 1

Configuration 2



Omega

Omega features two 18" radius corners that maximize usable worksurface.



large corner radius

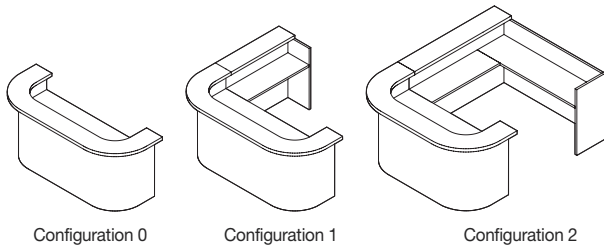

Configuration 0

Configuration 1

Configuration 2

Beta

Beta features one radius corner, and is available as desk only, desk and return, and desk, bridge and rear credenza.



radius corner

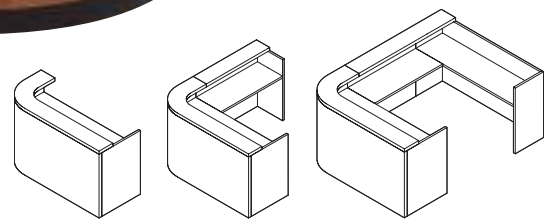

Configuration 0

Configuration 1

Configuration 2

Aspen



Aspen features an 18" deep bow-shaped counter, kerf reveal around toe kick, and contemporary edge detail at worksurface height.



optional grommets

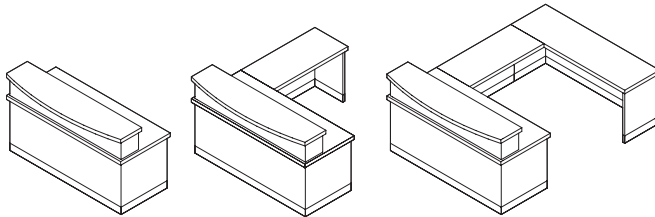

Configuration 0

Configuration 1

Configuration 2



contemporary edging





Galleria features a rectilinear, L-shaped counter and mitered corners.



configuration 0



configuration 2

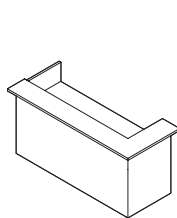

Configuration 0

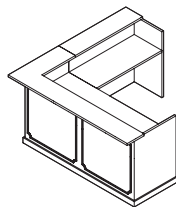

Configuration 1

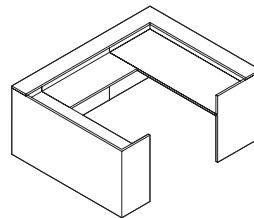

Configuration 2

Credenzas

ARD credenzas are available in six styles. Credenzas have the flexibility to come with drawers or doors for hanging files or storage.



Modena Style
(see page 14)

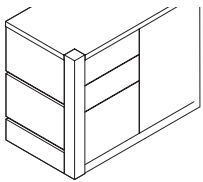

Siena Style
(see page 13)

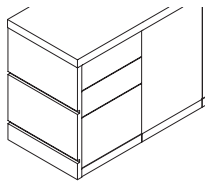

Kent Style
(see page 15)

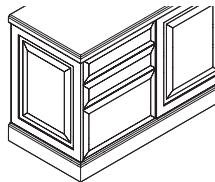

Prismo Style
(see page 6)

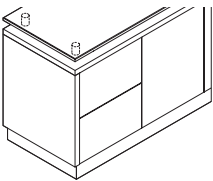

Somerset Style
(see page 18)

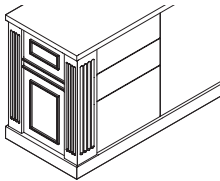

Ascona Style
(see page 20)

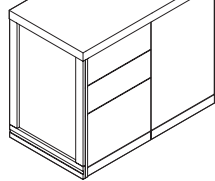

glass top



wood top

ARD Finishes

wood

Group 1 Walnut



Oak

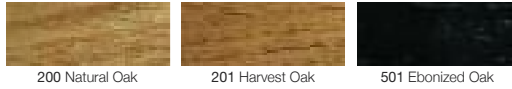

Mahogany

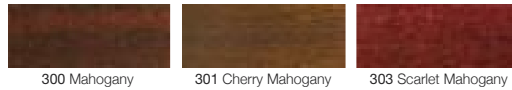

Cherry

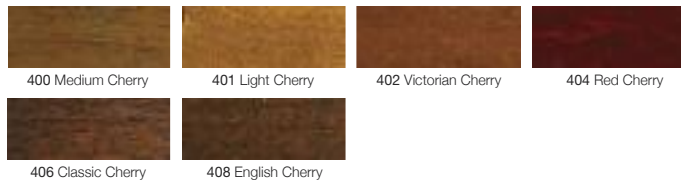

Maple

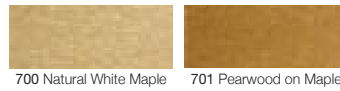

Group 2 Anigre



Group 3 Solid Colors

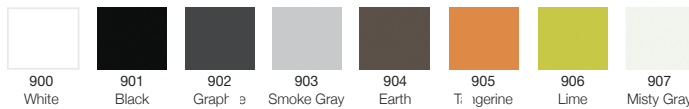

stone

Marble & Limestone



*Use granite pricing for White Calacatta Gold Marble. Consult factory for other available stone.

Granite

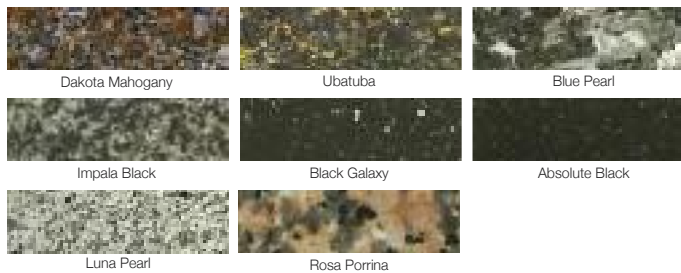

metal

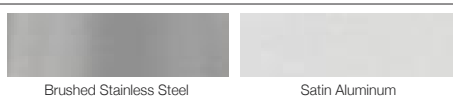

These printed swatches are simulations, and are intended for **preliminary selection only**. There may be minor variations in a finish since each tree has its own natural characteristics and can differ in color as it ages. **Always examine actual wood samples** from Arnold Reception Desks to confirm the preferred wood finish prior to ordering. We do not recommend comparing wood finishes to another manufacturer because of such inevitable natural variations.

For more information, please call us at (800) 306-0076 or visit us at **ardesk.com**.

Edge Details

B edge
2" Bullnose



H edge
2" Square
Hardwood



Z edge
2" Transitional



R edge
2" Reeded



D edge
2" Duet



V edge
2" Bevel



T edge
2" Traditional



K edge
2" Kent



Pedestals & Cabinets

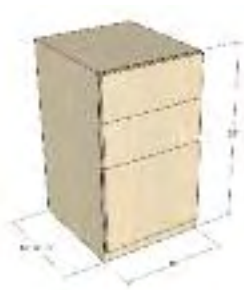

RPED 21
BBF pedestal with side lock

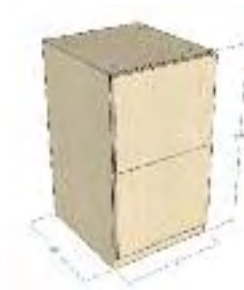

RPED 02
FF pedestal with side lock

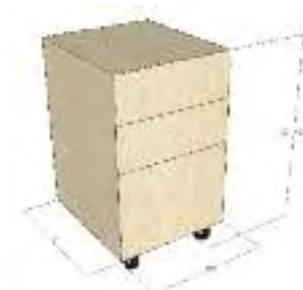

RMP 21
Mobile BBF pedestal
with front lock

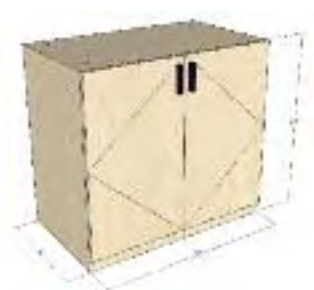

RDC 30
30" wide 2-door cabinet
with adjustable wood shelf
and standard ARD pulls

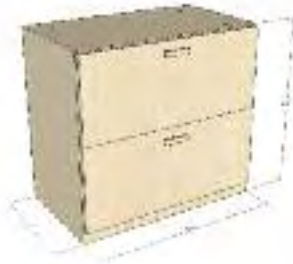

RFL 30
30" lateral file with standard
ARD pulls and front lock



RFL 36
36" lateral file

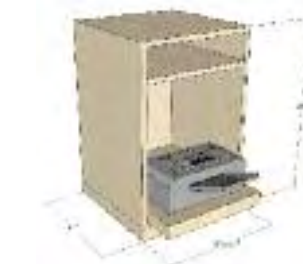

RPC 18
Printer cabinet with
1 fixed shelf and an
18" wide pull-out shelf



RDC 60
60" wide 4-door cabinet
with 2 adjustable wood shelves
and standard ARD pulls

Counters



Stone inlay with wood edge



Corian or Quartz

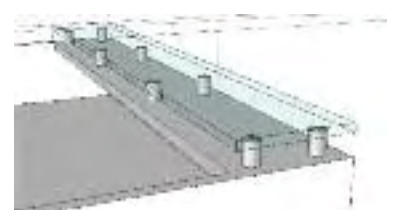

Clear or frosted glass
on metal stand-offs

Pulls & Knobs



Tab-Satin
Flat satin aluminum pull



Tab-Black
Flat black metal pull



C-Satin
Crescent shaped satin chrome pull



C-Black
Crescent shaped black metal pull



P-Satin
Prismo style satin aluminum pull



P-Satin
Prismo style satin aluminum knob



R-Satin
Recessed satin chrome pull



R-Black
Recessed black pull



S-Brass
Somerset style brass pull



S-Brass
Somerset style brass knob



S-Chrome
Somerset style chrome pull

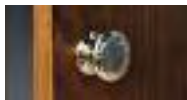

S-Chrome
Somerset style chrome knob



T-Brass
Antique brass bail type pull



T-Brass
Antique brass door knob



K-Satin
Kubist style flat satin aluminum pull



K-Satin
Kubist style flat satin aluminum door pull



K-Stainless
Kubist style stainless pull

Desk Options

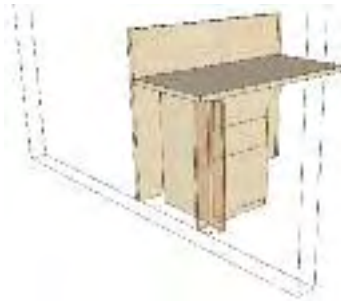

R11 Pedestal Receptacle Access Flap
hinged flap opens up to create a space to access wall outlets.



R10 Modesty Panel Receptacle Access Flap
hinged flap permits access to a wall outlet through an end panel or modesty panel.



R09 Monitor Well
hides monitor from visitors.



031 Articulating KBD
allows movement in and out, up and down, and swivels from side to side with an integrated mouse pad.

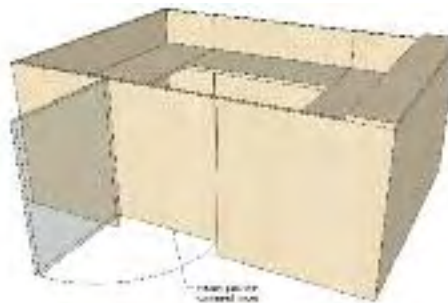

R08 Hinged Gate
provides privacy in reception desk or workstation.



Undercounter Organizers R05 / R04
R05 (for the left) and R04 (for the right) are organizers that typically fit below the countertop.

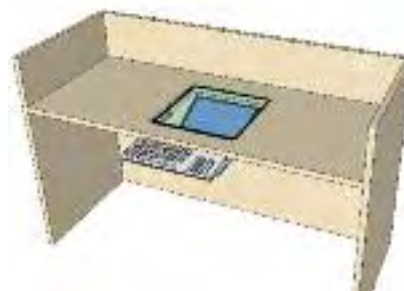

038 VDT Package
permits viewing of a flat screen through a cut-out in the worksurface. Includes pull-out keyboard shelf.



036 J-Channels
are extruded resin cable troughs that come in two sizes, large and small. Reception desks typically ship with several lengths of the small size, but for installations requiring a lot of cabling, the larger size is recommended. Call the factory for pricing.

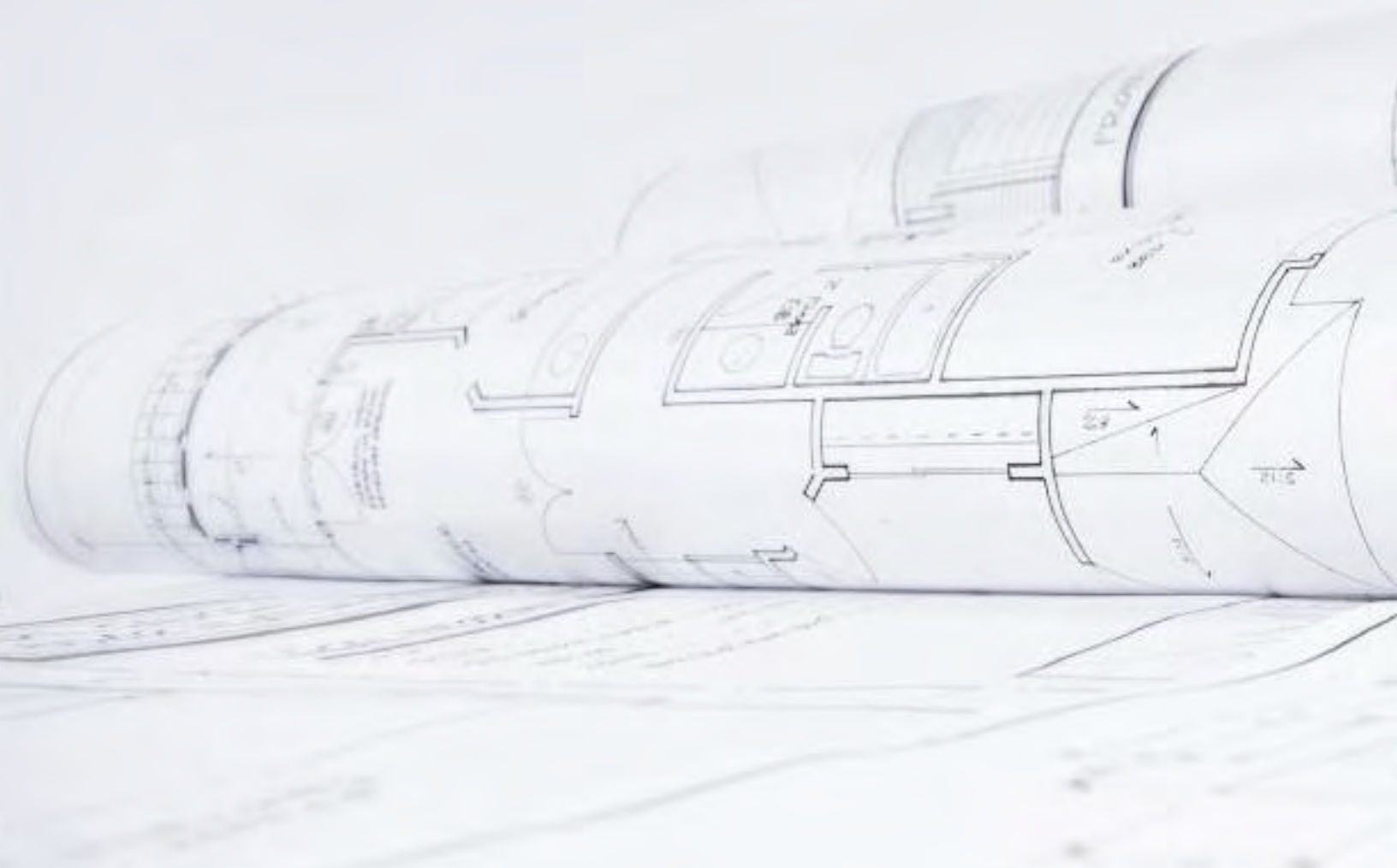

RECEPTION DESKS / WOOD WORKSTATIONS /
COURTROOM FURNITURE / LOBBY DESKS

120 Coit Street • Irvington, NJ 07111 • (800) 306-0076 • Fax (973) 375-8090 • info@ardesk.com

www.ardesk.com

Volume #5

 Made in the U.S.A.

Arnold Reception Desks, Inc. is committed to doing our part to save the environment. We operate responsibly and use only recycled paper stock for our printed materials. This piece is printed on paper that contains 10% post consumer waste and is FSC Chain of Custody.



Mixed Sources
Product group from well-managed
forests, controlled sources and
recycled wood or fiber.
Cert no. SGS-COC-007099
www.fsc.org
1996 Forest Stewardship Council